

DERBI

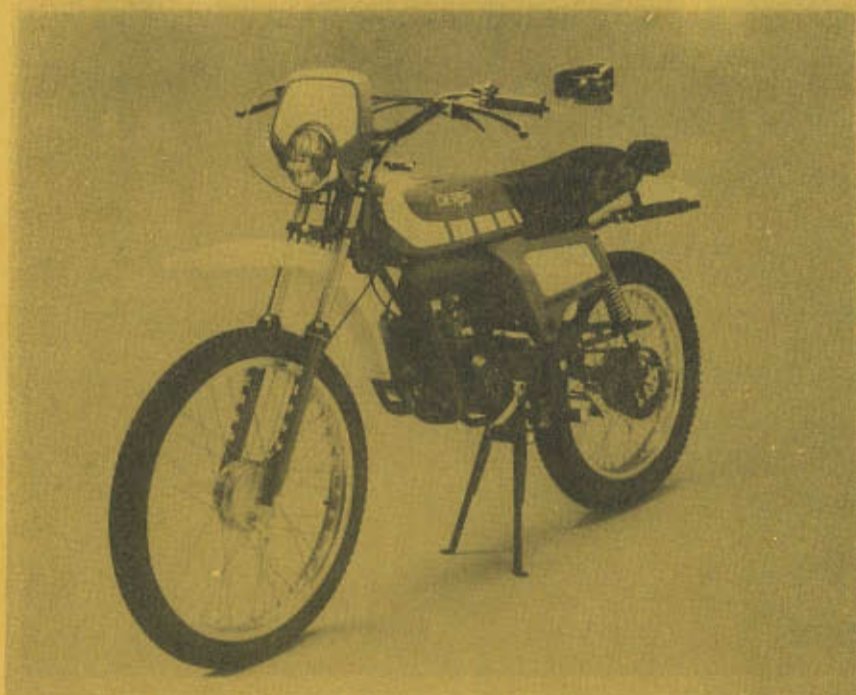

\$1.00

C-5 DIABLO



PARTS CATALOG



DERBI MOTOR CORPORATION OF AMERICA

23011 Alcalde Drive • Suite A • Laguna Hills, CA 92653 • (714) 770-6726

DOWNLOADED FROM THE PUBLIC SCOOTERHULP LIBRARY Outside California (800) 854-8306

www.ScooterHulp.com 

DERBI MOTOR CORPORATION OF AMERICA

INDEX OF DRAWINGS

GROUPS: 01 CHASSIS - 03 SWING ARM - 08 KICKSTAND	DRAWING NO. 1
GROUP: 02 FORK	DRAWING NO. 2
GROUPS: 04 GAS TANK - 05 AIR BOX/SIDE COVERS - 06 SEAT - 07 FENDERS - 15 CHASSIS COMPONENTS	DRAWING NO. 3
GROUP: 09 HANDLEBARS AND CONTROLS	DRAWING NO. 4
GROUP: 10 ELECTRICAL/LIGHTING SYSTEM	DRAWING NO. 5
GROUPS: 11 FOOT BRAKE - 12 FRONT WHEEL - 13 REAR WHEEL	DRAWING NO. 6
GROUP: 16 SPEEDOMETER	DRAWING NO. 7
GROUPS: 25 CYLINDER/CRANKSHAFT - 31 COMPRESSION RELEASE	DRAWING NO. 8
GROUP: 26 VARIATOR	DRAWING NO. 9
GROUP: 28 TRANSMISSION	DRAWING NO. 10
GROUP: 30 CRANKCASE	DRAWING NO. 11
GROUP: 32 CARBURETOR	DRAWING NO. 12
GROUP: 33 MAGNETO	DRAWING NO. 13
GROUP: 34 EXHAUST SYSTEM	DRAWING NO. 14
GROUP: 35 PEDAL DRIVE	DRAWING NO. 15
GROUP: 51 TOOL KIT	DRAWING NO. 16

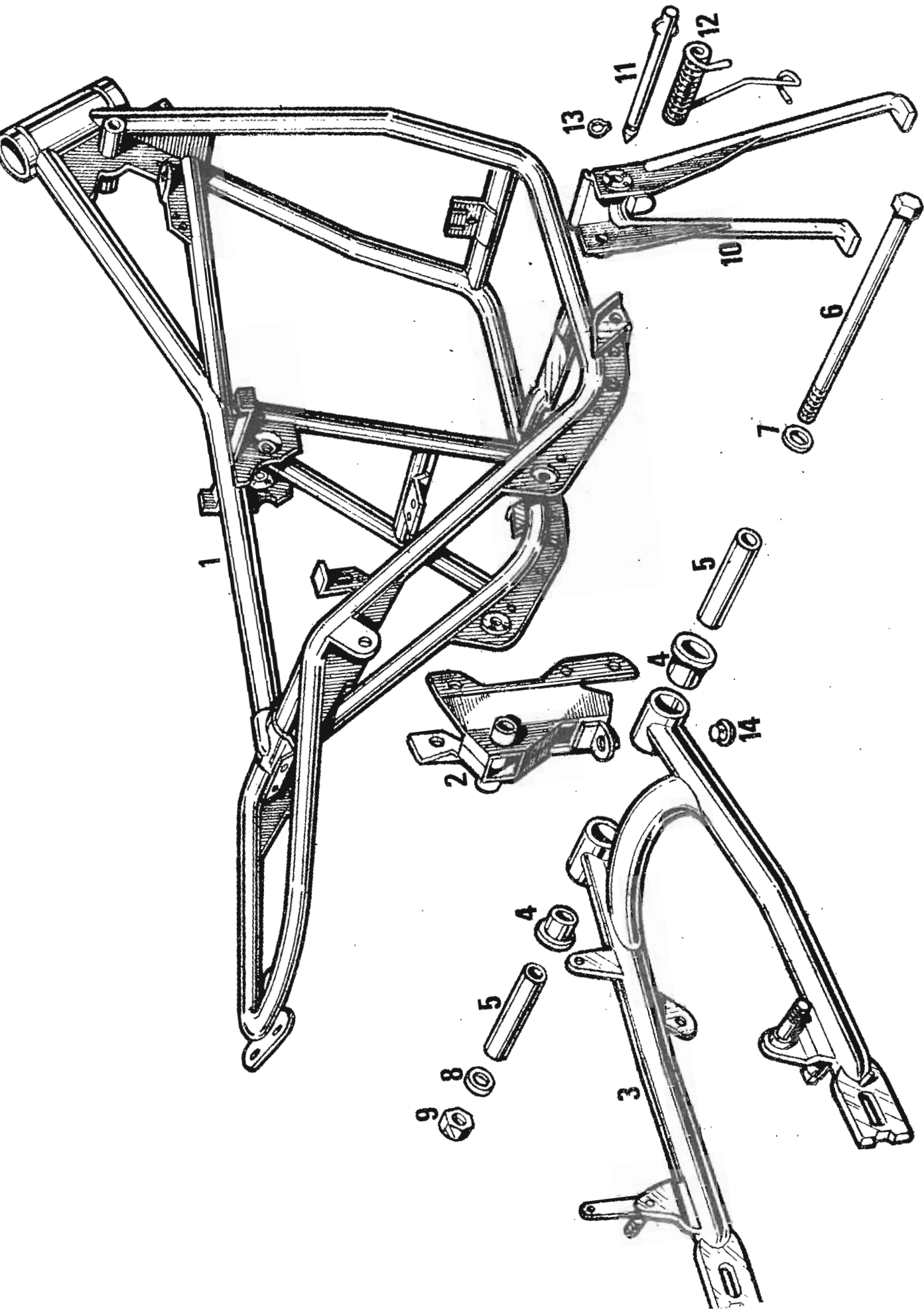

DIAGRAM NO. 1

GROUP: 01 CHASSIS
 03 SWING ARM
 08 KICK STAND

	<u>PART NUMBER</u>	<u>DESCRIPTION</u>	<u>PARTS PER GROUP</u>
1	79.01.01.0	FRAME CHASSIS, BLACK	1
2	79.01.96.0	MOUNT, REAR MOTOR	1
3	79.03.01.0	SWING ARM	1
4	25.03.23.0	BUSHING, SWING ARM	2
5	43.03.40.0	BUSHING, INNER PIVOT	2
6	25.03.41.0	AXLE, SWING ARM	1
7	31.15.42.0	WASHER, 12MM	1
8	31.12.32.0	WASHER, 12MM	1
9	00.21.12.0	NUT, 12MM X 1.50	1
10	79.08.01.0	STAND	1
11	79.08.07.0	PIVOT PIN, STAND	1
12	79.08.08.0	SPRING, STAND RETURN	1
13	00.471.10	CIRCLIP	1
14	31.08.06.0	RUBBER STOP, STAND	1

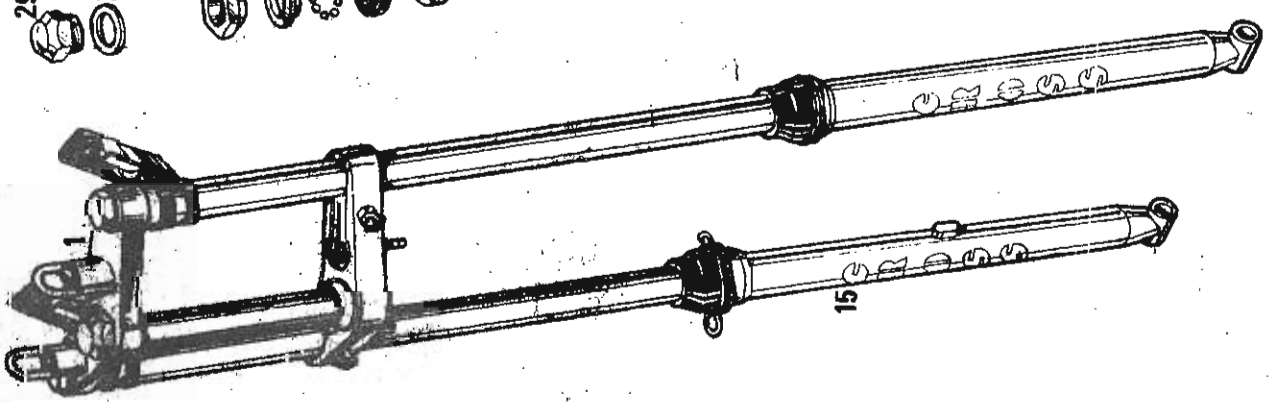
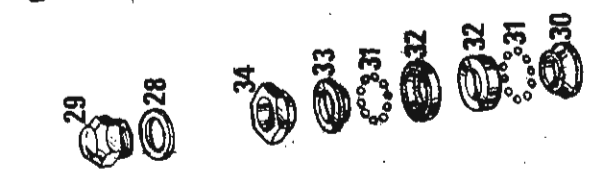
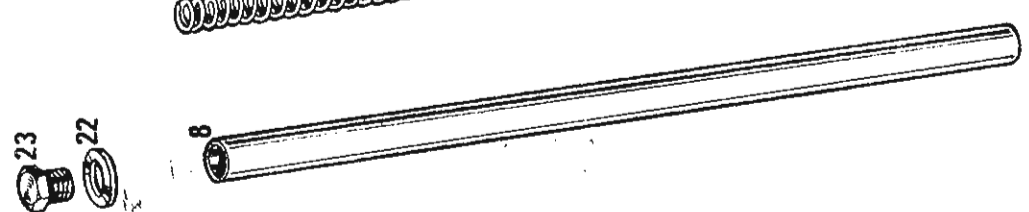
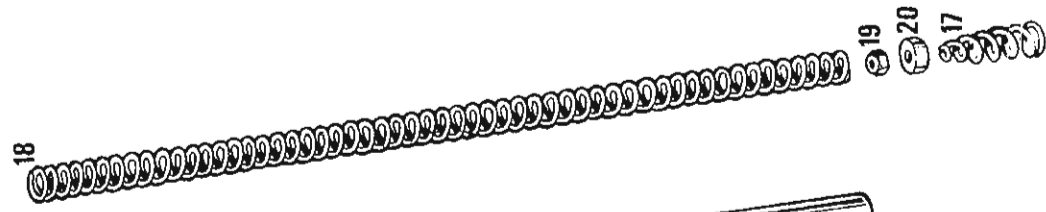
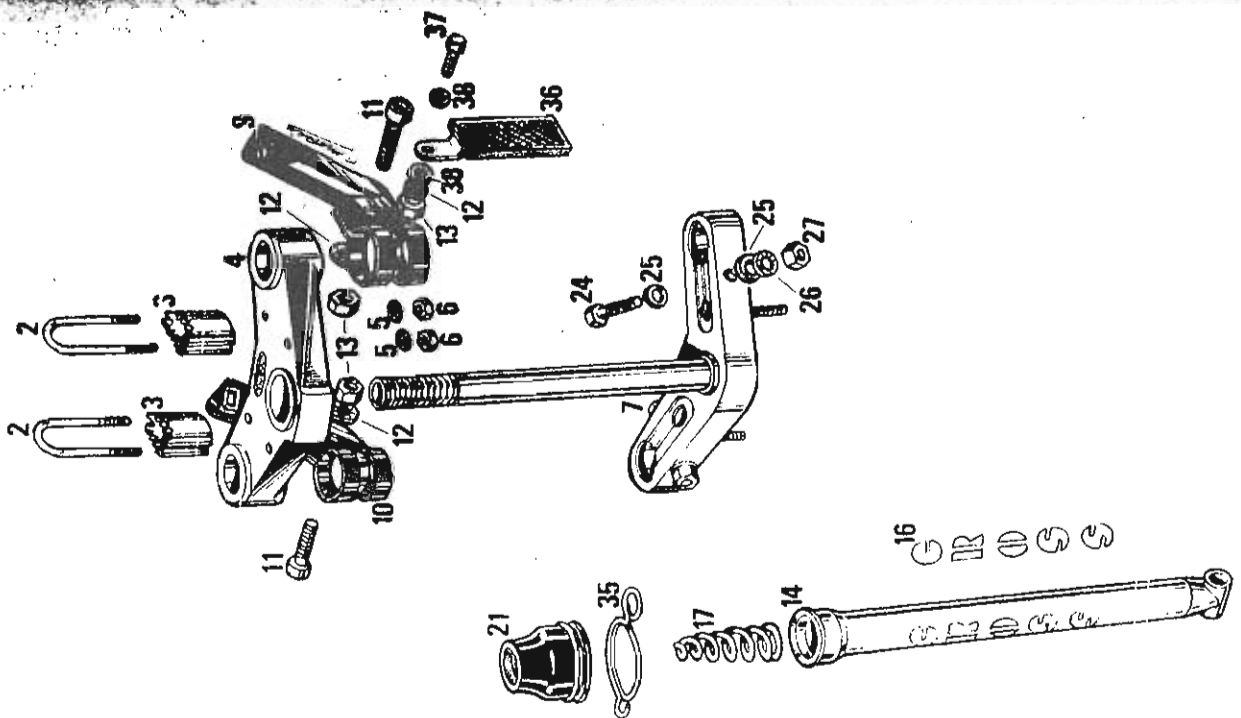

DIAGRAM 2

GROUP: 02 FORK

	<u>PART NUMBER</u>	<u>DESCRIPTION</u>	<u>PARTS PER GROUP</u>
1	25.02.00.2	FRONT FORK ASSEMBLY	1
2	89.02.74.0	CLAMP, HANDLEBAR	2
3	28.02.79.1	BASE, HANDLEBAR MOUNT	2
4	28.02.09.0	TRIPLE CLAMP, UPPER	1
5	00.34.07.0	WASHER, INTERIOR STAR, 7MM	4
6	31.25.29.0	NUT, 7MM	4
7	28.02.01.1	TRIPLE CLAMP, LOWER	1
8	25.02.89.0	FORK LEG, UPPER	2
9	50.02.24.3	MOUNT, HEADLIGHT, R.H.	1
10	50.02.25.3	MOUNT, HEADLIGHT, L.H.	1
11	00.04.6.15	ALLEN SCREW, 6M X 1.0 X 15M	2
12	00.34.06.0	WASHER, INTERIOR STAR, 6M	4
13	00.21.06.0	NUT, 6M X 1.00	4
14	25.02.13.0	FORK SLIDER, R.H.	1
15	25.02.12.0	FORK SLIDER, L.H.	1
16	28.20.05.0	DECAL, "CROSS", VERTICAL	2
17	25.02.88.0	SPRING, BOTTOMING CUSHION	4
18	65.02.17.0	SPRING, FORK	2
19	00.23.06.0	NUT, LOCKING, 6M X 1.00	2
20	25.20.26.0	SPACER	2
21	25.02.23.1	DUST COVER, FRONT FORK	2
22	89.02.63.0	WASHER, FORK CAP	2
23	89.02.27.0	CAP, FRONT FORK	2
24	00.02.8.55	BOLT, HEXHEAD, 8M X 1.25 X 55M	2
25	00.31.08.0	WASHER FLAT, 8M	4
26	00.34.08.0	WASHER, INTERNAL STAR, 8M	2
27	00.21.08.0	NUT, 8M X 1.25	2
28	31.02.10.0	WASHER, FORK STEM	1
29	19.02.11.0	NUT, FORK STEM	1
30	31.02.07.0	BEARING RACE, LOWER FORK STEM	1
31	00.61.04.0	BALL, BEARING 3/16	46
32	31.02.06.0	BEARING RETAINER	2
33	31.02.07.1	BEARING RACE UPPER FORK STEM	1
34	31.02.08.1	NUT, FORK STEM	1
35	25.02.81.0	CLIP, DUST COVER RETAINING	1
36	50.18.08.0	REFLECTOR	2
37	00.02.6.15	BOLT, HEXHEAD, 6M X 1.00 X 15	2

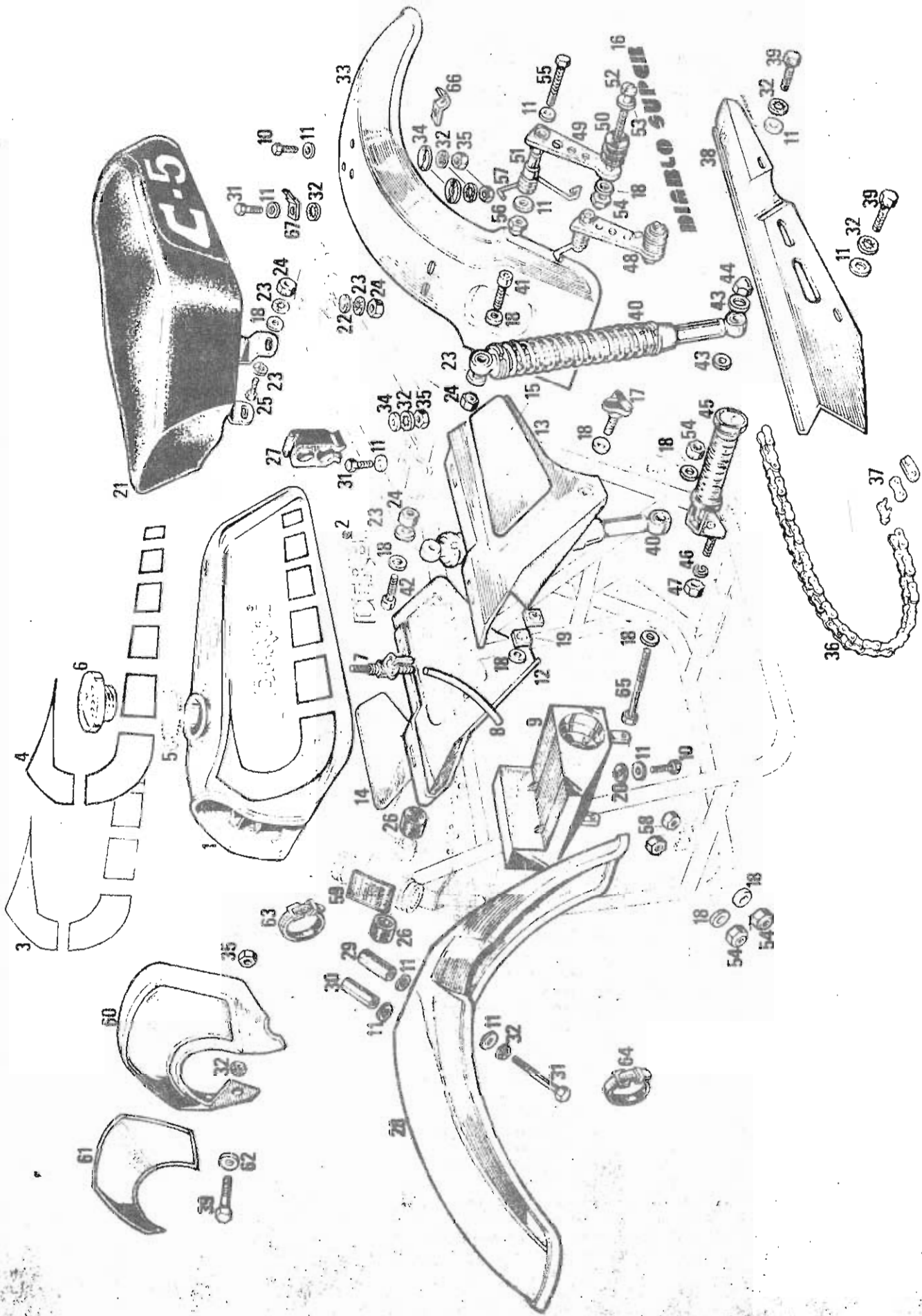

DIAGRAM NO. 3

GROUP: 04 GAS TANK, 05 AIR BOX & SIDE COVERS
07 FENDERS, 15 CHASSIS COMPONENTS

<u>PART NUMBER</u>	<u>DESCRIPTION</u>	<u>PARTS PER GROUP</u>
1	25.04.54.0 FUEL TANK, RED	1
2	25.04.11.0 DECAL, "DERBI"	2
3	25.04.44.2 DECAL, GRAPHICS, R.H. WHITE	1
4	25.04.12.2 DECAL, GRAPHICS, L.H. WHITE	1
5	65.04.52.1 DECAL, MIX RECOMMENDATION	1
6	86.04.13.0 CAP, GAS TANK	1
7	19.04.18.1 VALVE, FUEL	1
8	81.04.32.0 FUEL LINE, RUBBER	1
9	25.05.47.0 AIR BOX	1
10	00.02.6.20 BOLT, HEXHEAD, 6M X 1.00 X 20	4
11	00.31.06.0 WASHER, FLAT 6M	14
12	25.05.07.0 SIDEPANEL, R.H. RED	1
13	25.05.08.0 SIDEPANEL, L.H. RED	1
14	25.05.19.0 DECAL, SIDEPANEL, R.H.	1
15	25.05.15.0 DECAL, SIDEPANEL, L.H.	1
16	33.05.19.0 DECAL, "SUPER DIABLO"	2
17	25.05.13.0 BOLT, SIDEPANEL RETAINING	2
18	00.31.08.0 WASHER, FLAT, 8M	14
19	31.05.21.0 CUSHION, NYLON	2
20	35.15.06.0 WASHER, RUBBER CUSHION	2
21	79.06.01.0 SEAT, C-5	1
22	33.06.57.0 WASHER	1
23	00.34.08.0 WASHER, INTERIOR STAR, 8M	7
24	00.21.08.0 NUT, 8M X 1.25	4
25	00.02.8.15 BOLT, HEXHEAD, 8M X 1.25 X 15	2
26	33.15.05.0 CUSHION, GAS TANK MOUNT, FRONT	2
27	33.15.06.0 CUSHION, GAS TANK MOUNT, REAR	1
28	25.07.02.0 FENDER, FRONT, WHITE	1
29	79.07.32.0 SPACER, FRONT FENDER REAR	2
30	79.07.36.0 SPACER, FRONT FENDER, FORWARD	2
31	00.02.6.15 BOLT, HEX HEAD, 6M X 1.00 X 15M	6
32	00.34.06.0 WASHER, INTERNAL STAR 6M	13
33	79.07.12.0 FENDER, REAR, WHITE	1
34	31.10.61.0 WASHER, FENDER, 6M	4
35	00.21.06.0 NUT, 6M X 1.00	6
36	65.15.20.0 CHAIN, DRIVE, LINK	1
37	31.15.21.0 MASTER LINK	1
38	33.15.18.0 CHAIN GUARD	1
39	00.02.6.10 BOLT, HEX HEAD, 6M X 1.00 X 10M	4
40	79.15.19.0 SHOCK ABSORBER	2
41	00.04.8.50 ALLEN BOLT, 8M X 1.25 X 50M	1
42	00.04.8.45 ALLEN BOLT, 8M X 1.25 X 45M	1
43	31.15.42.0 WASHER, 12M	4
44	31.15.41.0 NUT, ACORN, 12M X 1.25	2
45	79.15.09.0 FOOT PEG, FOLDING	2
46	00.33.10.0 WASHER, LOCK, 10M	2
47	00.21.10.0 NUT, 10M X 1.50	2
48	25.18.74.0 CHAIN TENSIONER ASSEMBLY	1
49	25.18.80.0 ARM, CHAIN TENSIONER	1
50	28.18.77.0 ROLLER, CHAIN TENSIONER	1
51	28.18.78.0 PIVOT, CHAIN TENSIONER	1
52	28.18.85.0 AXLE, CHAIN TENSIONER ROLLER	1
53	00.31.10.0 WASHER, FLAT, 10M	1
54	00.23.08.0 NUT, LOCKING, 8M X 1.25	5
55	65.13.49.0 BOLT, CHAIN TENSIONER PIVOT	1
56	00.23.06.0 NUT, ACORN, 6M X 1.00	1
57	28.18.76.0 SPRING, CHAIN TENSIONER	1
58	25.22.24.0 SPACER, MOTOR MOUNT	2
59	79.18.10.1 LABEL, IDENTIFICATION	1
60	25.15.28.0 NUMBER PLATE, FRONT	1
61	25.15.32.0 DECAL, NUMBER PLATE, FRONT	1
62	82.22.08.0 WASHER	2
63	55.09.53.0 CABLE STRAP	3
64	68.09.53.1 CABLE STRAP	3
65	00.02.8.99 BOLT, HEX HEAD, 8M X 1.25 X 100M	2
66	55.10.98.0 RETAINER, WIRE	5
67	50.10.66.1 TERMINAL, GROUND	1

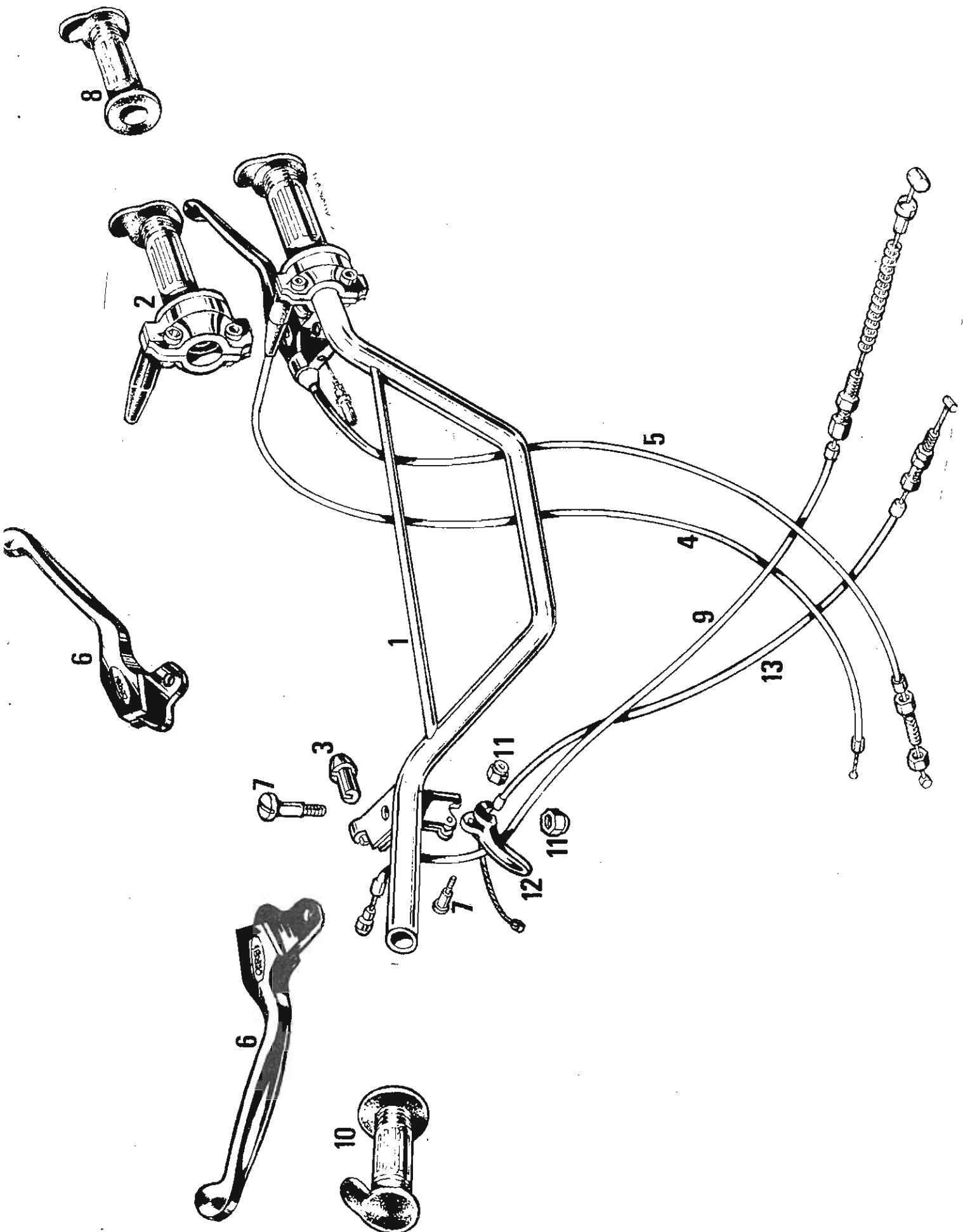

DIAGRAM NO. 4

GROUP: 09 HANDLEBARS

	<u>PART NUMBER</u>	<u>DESCRIPTION</u>	<u>PARTS PER GROUP</u>
1	79.09.01.3	HANDLEBAR	1
2	28.09.08.0	THROTTLE ASSEMBLY	1
3	31.09.22.0	HOLDER, CABLE	2
4	28.09.17.0	CABLE, THROTTLE	1
5	79.09.23.0	CABLE, FRONT BRAKE	1
6	81.09.20.1	LEVER, HAND BRAKE	2
7	31.09.21.0	BOLT, HAND LEVER PIVOT	3
8	28.09.09.0	GRIP, HANDLE, R.H.	1
9	79.09.43.1	CABLE, REAR BRAKE	1
10	28.09.07.0	GRIP, HANDLE, L.H.	1
11	00.23.05.0	NUT, LOCKING, 5M X .80	3
12	82.09.39.0	LEVER, COMPRESSION RELEASE	1
13	82.09.40.0	CABLE, COMPRESSION RELEASE	1

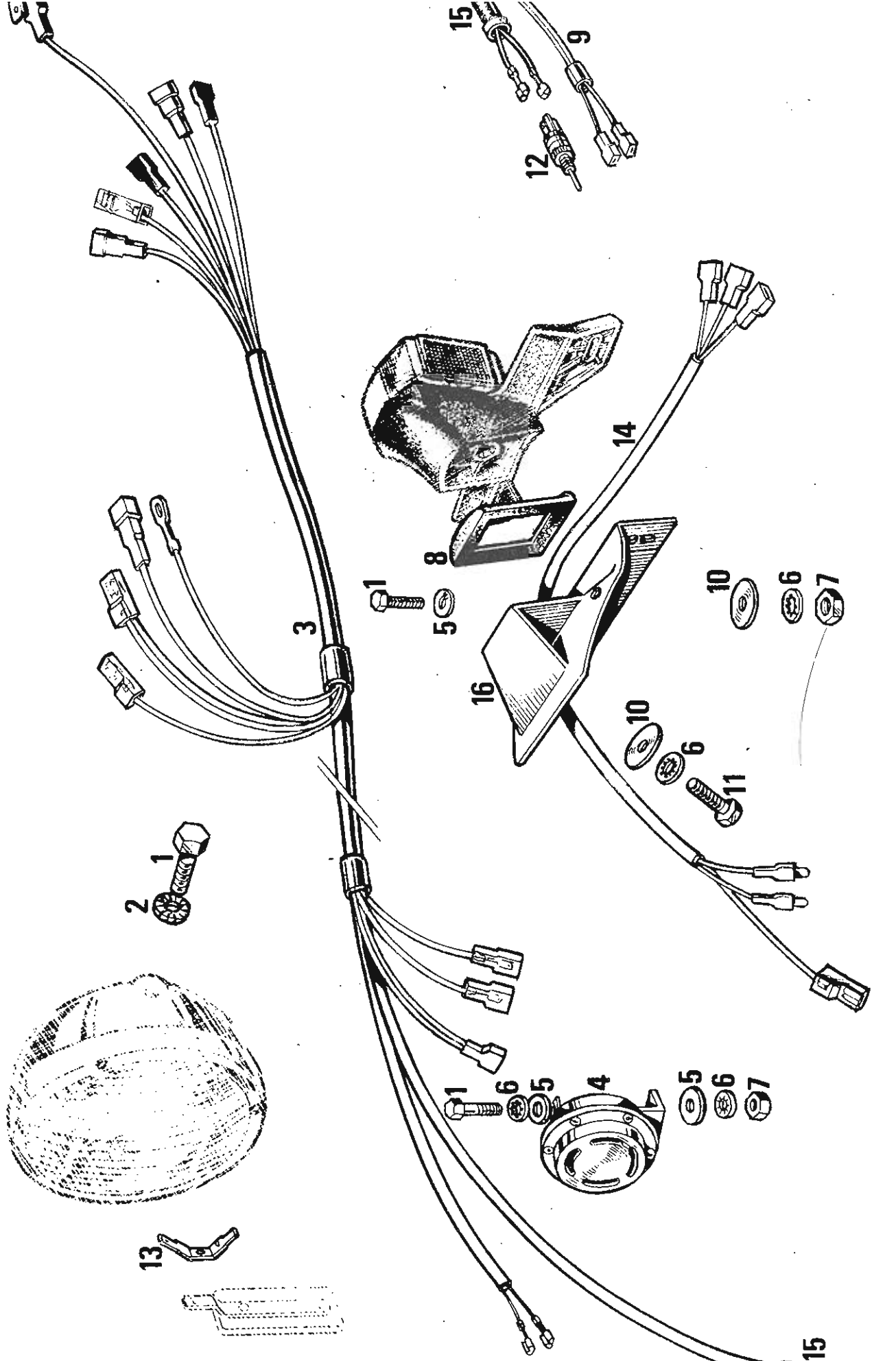

DIAGRAM NO. 5

GROUP: 10 LIGHTING

	<u>PART NUMBER</u>	<u>DESCRIPTION</u>	<u>PARTS PER GROUP</u>
1	00.02.6.15	BOLT, HEX HEAD, 6M X 1.00 X 15M	5
2	00.35.06.0	WASHER, EXTERIOR STAR	2
3	79.10.30.1	WIRING LOOM, MAIN	1
4	79.10.31.1	HORN	1
5	00.31.06.0	WASHER FLAT, 6M	4
6	00.34.06.0	WASHER, INTERNAL STAR, 6M	5
7	00.21.06.0	NUT, 6M X 1.00	2
8	50.10.33.0	GASKET, TAIL LIGHT MOUNTING	1
9	50.23.22.1	WIRE LOOM, STOPLIGHT SWITCH	1
10	31.10.61.0	WASHER, FENDER, 6M	3
11	00.02.6.10	BOLT, HEX HEAD, 6M X 1.00 X 10M	1
12	50.23.20.0	SWITCH, STOP LIGHT	2
13	55.10.62.0	TERMINAL, DOUBLE GROUND	1
14	79.10.95.0	WIRE LOOM TAIL LIGHT	1
15	50.10.76.0	COVER, STOP LIGHT SWITCH	2
16	79.15.28.0	BRACKET, TAIL LIGHT MOUNTING	1

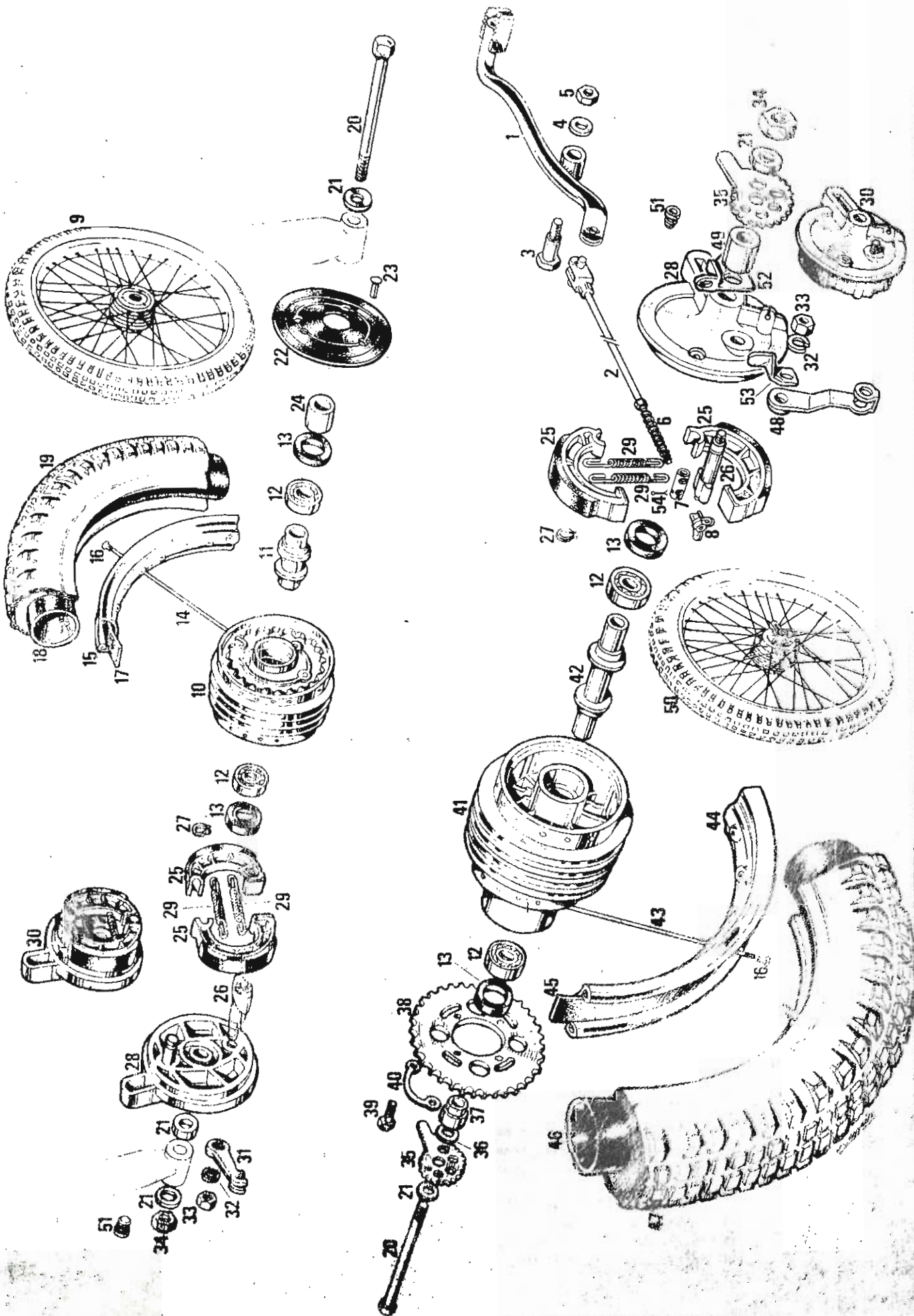

DIAGRAM NO. 6

GROUP: 11 FOOT BRAKE
 12 FRONT WHEEL
 13 REAR WHEEL

<u>PART NUMBER</u>	<u>DESCRIPTION</u>	<u>PARTS PER GROUP</u>
1	79.11.01.0 LEVER, FOOT, REAR BRAKE	1
2	79.09.43.0 CABLE, REAR BRAKE, FOOT	1
3	43.11.17.0 BOLT, BRAKE LEVER, PIVOT	1
4	00.31.08.0 WASHER, FLAT, 8M	1
5	00.23.08.0 NUT, 8M X 1.25	1
6	31.11.09.0 SPRING, CABLE	1
7	79.11.11.0 HOLDER, REAR BRAKE CABLE END	1
8	82.11.12.0 ADJUSTER, FOOT BRAKE CABLE	1
9	79.12.00.0 WHEEL ASSY. FRONT (W/O TIRE OR BACKING PLATE)	1
10	65.12.63.0 HUB FRONT (W/O BEARINGS)	1
11	31.12.03.0 SPACER, FRONT WHEEL BEARING	1
12	00.56.201 BEARING, WHEEL	4
13	31.12.34.1 SEAL, WHEEL BEARING	4
14	79.12.06.0 SPOKE, FRONT WHEEL	36
15	79.12.08.1 RIM 1.40 X 21 ALLOY	1
16	31.12.07.0 NIPPLE, SPOKE	72
17	28.12.09.0 RIMBAND	1
18	28.12.10.0 TUBE	1
19	79.12.11.0 TIRE	1
20	21.12.26.0 AXLE, FRONT	2
21	31.12.31.0 WASHER, AXLE	5
22	09.12.12.0 COVER, FRONT HUB	1
23	31.12.13.0 RIVET, HUB COVER	3
24	89.12.29.0 SPACER, FRONT WHEEL	1
25	43.12.21.0 SHOE, BRAKE	4
26	43.12.77.0 CAM, BRAKE	2
27	00.471.10 CIRCLIP	2
28	50.12.14.0 BRAKE PLATE	2
29	31.12.24.0 SPRING, BRAKE SHOE RETURN	4
30	50.12.40.0 BRAKE PLATE ASSEMBLY	2
31	31.12.18.0 ARM, BRAKE ACTUATING, FRONT	1
32	00.33.10.0 WASHER, LOCK, 10M	2
33	31.13.15.0 NUT, 10M X 1.00	2
34	31.12.33.0 NUT, AXLE, 12M X 1.50	2
35	25.13.17.0 ADJUSTER, CHAIN	2
36	31.12.32.0 WASHER, 12M	1
37	79.13.18.0 SPACER, REAR WHEEL, L.H.	1
38	79.13.03.0 SPROCKET, 42 TOOTH	1
39	00.02.8.30 BOLT, HEX HEAD, 8 X 1.25 X 30	4
40	65.13.05.0 LOCK TAB, SPROCKET BOLT, REAR	2
41	82.13.08.0 HUB, REAR, (W/O BEARINGS)	1
42	82.13.09.0 SPACER WHEEL BEARING	1
43	65.12.06.1 SPOKE, REAR WHEEL	36
44	65.12.08.0 RIM, 2.25 X 18, ALLOY	1
45	28.13.40.0 RIM STRIP	1
46	28.13.36.0 TUBE	1
47	28.13.32.0 TIRE	1
48	79.13.11.0 ARM, REAR BRAKE	1
49	79.13.29.0 SPACER, REAR WHEEL, R.H.	1
50	79.13.00.0 WHEEL ASSEMBLY, REAR (W/O TIRE OR BACKING PLATE)	1
51	50.12.72.0 PLUG, INSPECTION	4
52	79.23.25.0 HOLDER, STOP LIGHT SWITCH	1
53	79.23.26.0 ACTUATOR, STOP LIGHT SWITCH	1
54	00.51.20.0 COTTER PIN	1

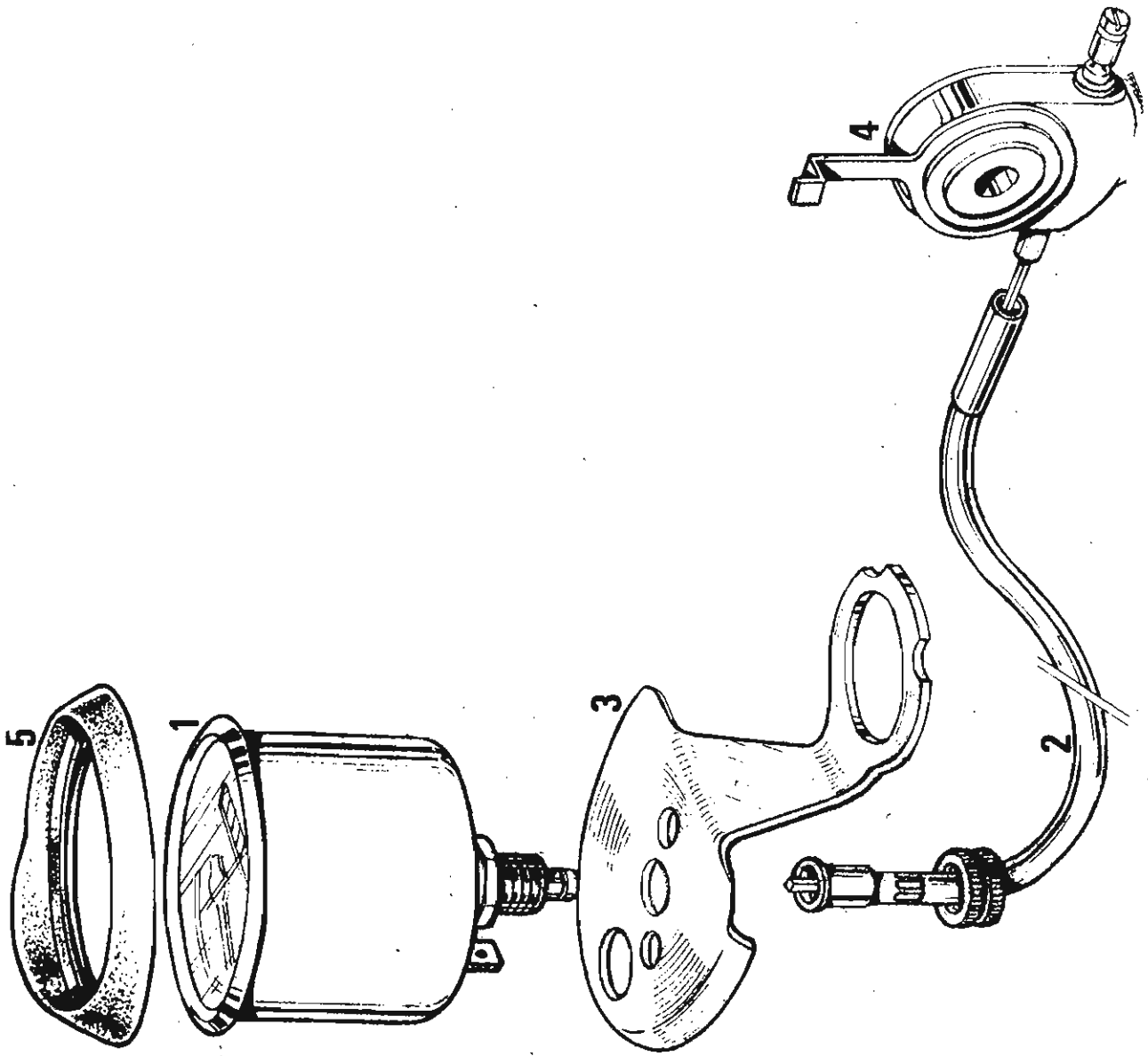

DIAGRAM NO. 7

GROUP: 16 SPEEDOMETER

	<u>PART NUMBER</u>	<u>DESCRIPTION</u>	<u>PARTS PER GROUP</u>
1	50.16.01.0	SPEEDOMETER	1
2	79.16.02.0	CABLE, SPEEDOMETER	1
3	82.16.22.1	MOUNT, SPEEDOMETER	1
4	58.16.05.0	DRIVE, SPEEDOMETER	1
5	82.16.83.0	TRIM RING, SPEEDOMETER	1

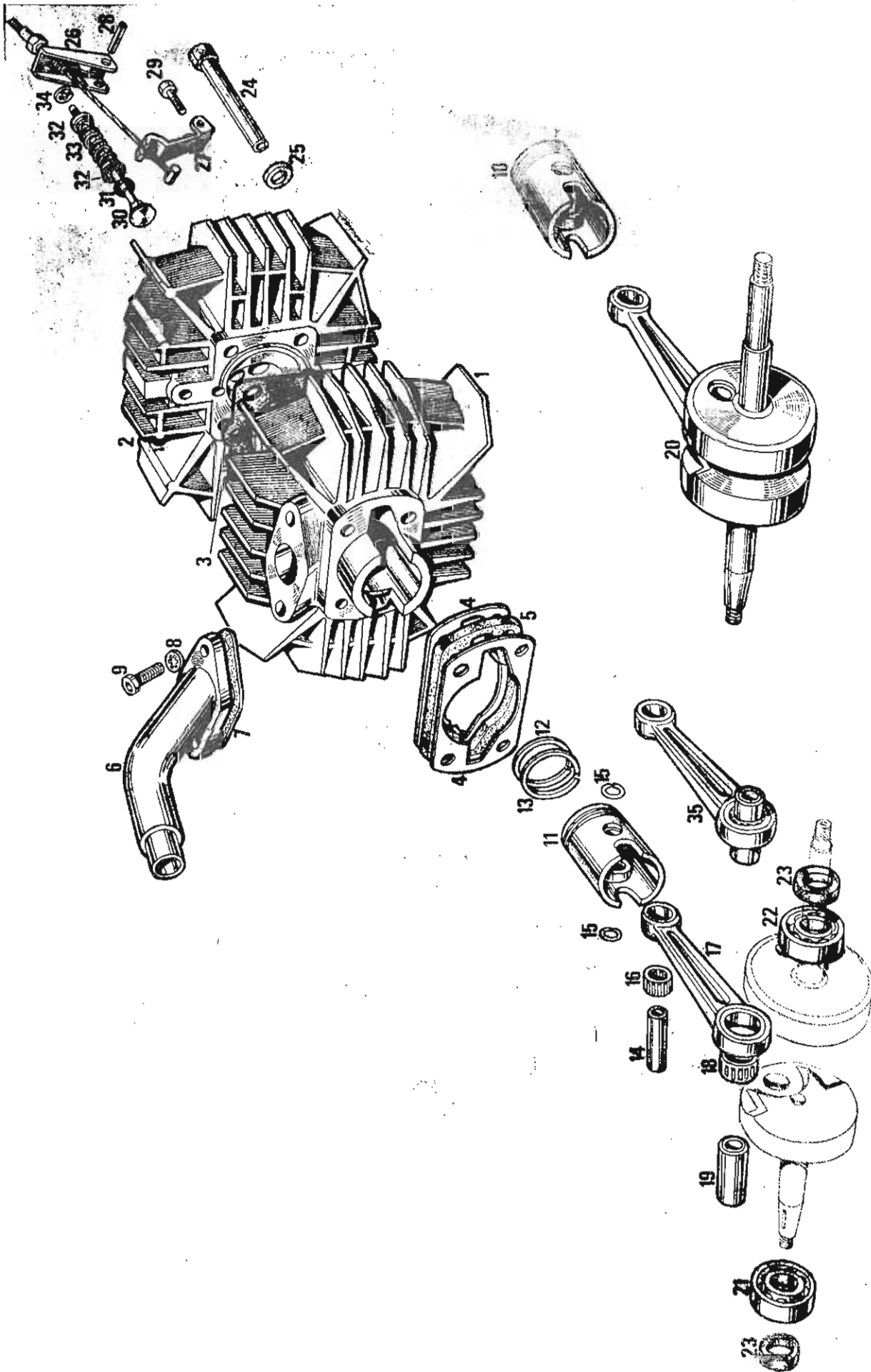

DIAGRAM NO. 8

GROUP: 25 CYLINDER/CRANKSHAFT
31 COMPRESSION RELEASE

	<u>PART NUMBER</u>	<u>DESCRIPTION</u>	<u>PARTS PER GROUP</u>
1	77.25.03.0	CYLINDER (WITH PISTON ASSY.) BLACK	1
2	79.25.01.0	HEAD, CYLINDER, BLACK	1
3	79.25.02.0	GASKET, CYLINDER HEAD	1
4	82.25.04.0	GASKET, BASE (.2MM)	2
5	82.25.57.0	GASKET, BASE (2.0MM)	1
6	80.25.06.0	MANIFOLD INLET	1
7	82.25.05.0	GASKET, INLET MANIFOLD	1
8	00.34.06.0	WASHER, INTERNAL STAR, 6M	2
9	00.04.6.20	ALLEN BOLT, 6M X 1.00 X 20	2
10	80.25.09.0	PISTON ASSY. STD.	2
11	80.25.10.0	PISTON ONLY	1
12	80.25.11.0	RINGS, STD. SET	1
13	67.25.11.0	RING, LOWER	1
14	31.25.12.0	PIN, PISTON	1
15	31.25.13.0	CIRCLIP	2
16	21.25.17.0	BEARING, PISTON PIN	1
17	08.25.16.0	CONNECTING ROD	1
18	82.25.18.0	BEARING, LOWER CONNECTING ROD	1
19	03.25.19.0	CRANK PIN	1
20	82.25.14.1	CRANKSHAFT ASSY.	1
21	00.57.213	BEARING, CRANKSHAFT, L.H.	1
22	00.57.303	BEARING, CRANKSHAFT, R.H.	1
23	61.25.23.0	SEAL, CRANKSHAFT	2
24	79.25.29.0	NUT, SLEEVE	4
25	65.25.53.0	WASHER, 10M	4
26	82.31.01.0	COMPRESSION RELEASE ASSEMBLY	1
27	"	" " "	1
28	"	" " "	1
29	"	" " "	1
30	"	" " "	1
31	"	" " "	1
32	"	" " "	2
33	"	" " "	1
34	"	" " "	1
35	82.50.01.0	CONNECTING ROD KIT	1

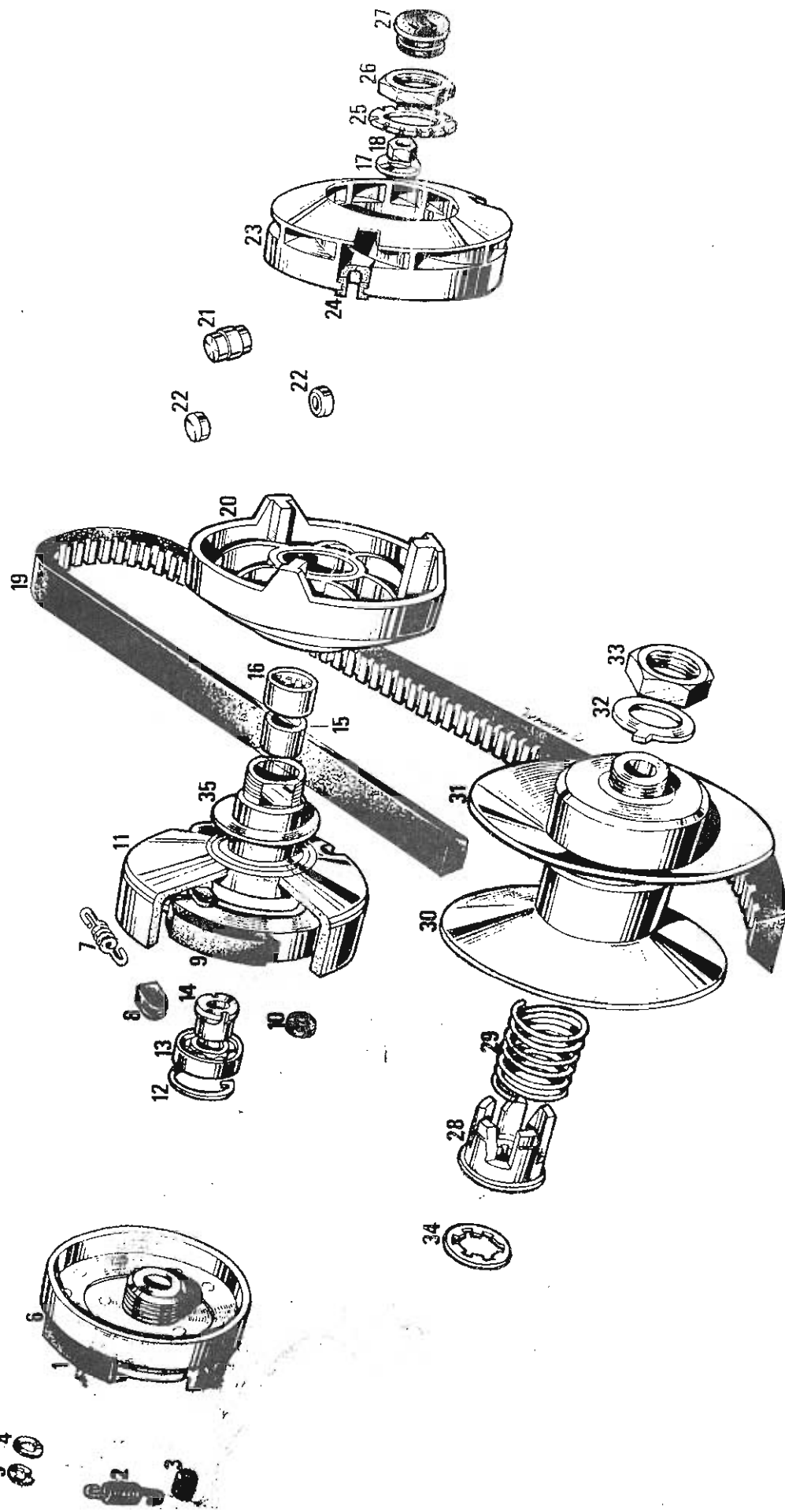

DIAGRAM NO. 9

GROUP: 26 VARIATOR

	<u>PART NUMBER</u>	<u>DESCRIPTION</u>	<u>PARTS PER GROUP</u>
1	82.36.27.0	SHOE, DRIVE CLUTCH	1
2	82.39.53.0	SPRING, DRIVE CLUTCH SHOE	3
3	82.26.44.0	BUSHING, RUBBER	3
4	82.26.41.0	SPACER, CLUTCH SHOE	3
5	00.473.08	CIRCLIP	3
6	82.26.82.0	MAIN CLUTCH ASSY.	1
7	82.26.77.0	SPRING, STARTING CLUTCH	2
8	82.26.07.0	CUSHION, RUBBER RETURN	2
9	82.26.15.0	SHOE, STARTING CLUTCH	1
10	82.26.33.0	BUSHING, NYLON	2
11	82.26.04.0	DRIVE PULLEY, MAIN SUB-ASSY.	1
12	00.472.32	CIRCLIP	1
13	00.57.201	BEARING, DRIVE CLUTCH	1
14	82.26.73.0	CAP, BEARING	1
15	82.26.48.0	BEARING RACE	1
16	82.26.72.0	BEARING, DRIVE PULLEY	1
17	65.25.53.0	WASHER, CRANKSHAFT, 10M	1
18	31.13.15.0	NUT, CRANKSHAFT, 10M X 1.00	1
19	82.26.37.0	BELT, TORQUE CONVERTER	1
20	82.26.46.0	PLATE, DRIVE PULLEY OUTER	1
21	82.36.11.0	CENTRIFUGAL WEIGHT ASSY.	3
22	82.26.42.0	SILENT BLOCK, CENTRIFUGAL WEIGHT	6
23	82.26.19.0	COVER, CENTRIFUGAL WEIGHT	1
24	82.36.09.0	GUIDE, CENTRIFUGAL WEIGHT COVER	3
25	82.26.24.1	WASHER, RETAINING	1
26	82.26.26.1	NUT, WEIGHT COVER	1
27	82.26.88.0	PLUG, DRIVE PULLEY	1
28	82.26.13.0	CAM, TORQUE CONVERTER	1
29	82.26.21.0	SPRING, DRIVEN PULLEY	1
30	80.26.12.0	INNER PULLEY, DRIVEN	1
31	80.36.16.0	OUTER PULLEY, DRIVEN	1
32	82.26.23.2	WASHER, EXTERNAL STAR	1
33	80.26.51.0	NUT, DRIVEN PULLEY	1
34	82.26.02.0	WASHER, SPLINED	1
35	50.36.19.0	WASHER, INTERMEDIATE, 1.5MM	1

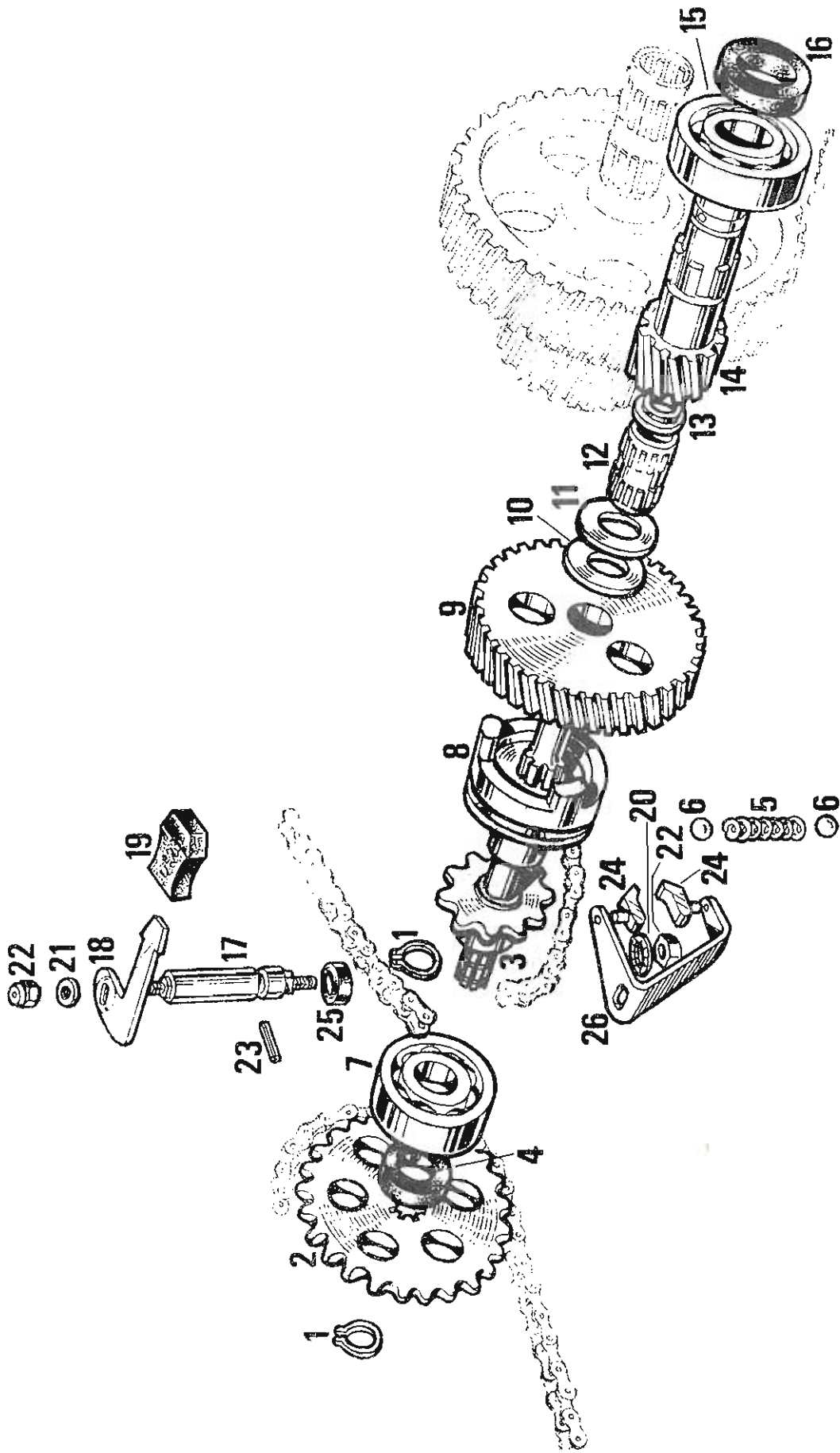

DIAGRAM NO. 10

GROUP: 28 TRANSMISSION

	<u>PART NUMBER</u>	<u>DESCRIPTION</u>	<u>PARTS PER GROUP</u>
1	00.471.15	CIRCLIP	2
2	82.28.37.3	SPROCKET, 20 TOOTH	1
3	50.28.13.0	DRIVE SHAFT, SUB-ASSY.	1
4	82.28.40.0	SEAL, TRANSMISSION, L.H.	1
5	31.27.20.0	SPRING, DETENT	1
6	00.61.04.0	BALL, BEARING	2
7	00.57.302	BEARING, TRANSMISSION, L.H., 6302	1
8	50.28.64.0	SHIFTING DOG	1
9	82.28.22.1	GEAR, TRANSMISSION 52 TOOTH	1
10	82.28.56.6	WASHER, THRUST	1
11	82.28.56.8	WASHER, THRUST	1
12	82.28.49.2	NEEDLE BEARING	1
13	82.28.28.0	RETAINER, BEARING	1
14	80.28.30.0	SHAFT, DRIVEN PULLEY	1
15	00.57.205	BEARING, DRIVEN PULLEY, 6205	1
16	82.30.46.1	SEAL, DRIVEN PULLEY SHAFT	1
17	82.28.06.0	SHAFT, SHIFTER	1
18	79.28.05.0	ARM, SHIFTER	1
19	82.28.93.0	COVER, SHIFTER ARM, RUBBER	1
20	00.34.06.0	WASHER, INTERNAL STAR, 6M	1
21	00.31.06.0	WASHER, FLAT, 6M	1
22	00.23.06.0	NUT, LOCKING, 6MM	2
23	82.28.08.0	PIN, SHIFT SHAFT	1
24	82.28.10.0	BUSHING, SHIFTER THRUST	2
25	82.28.36.0	SEAL, SHIFT SHAFT	1
26	82.28.09.0	FORK, SHIFTER	1

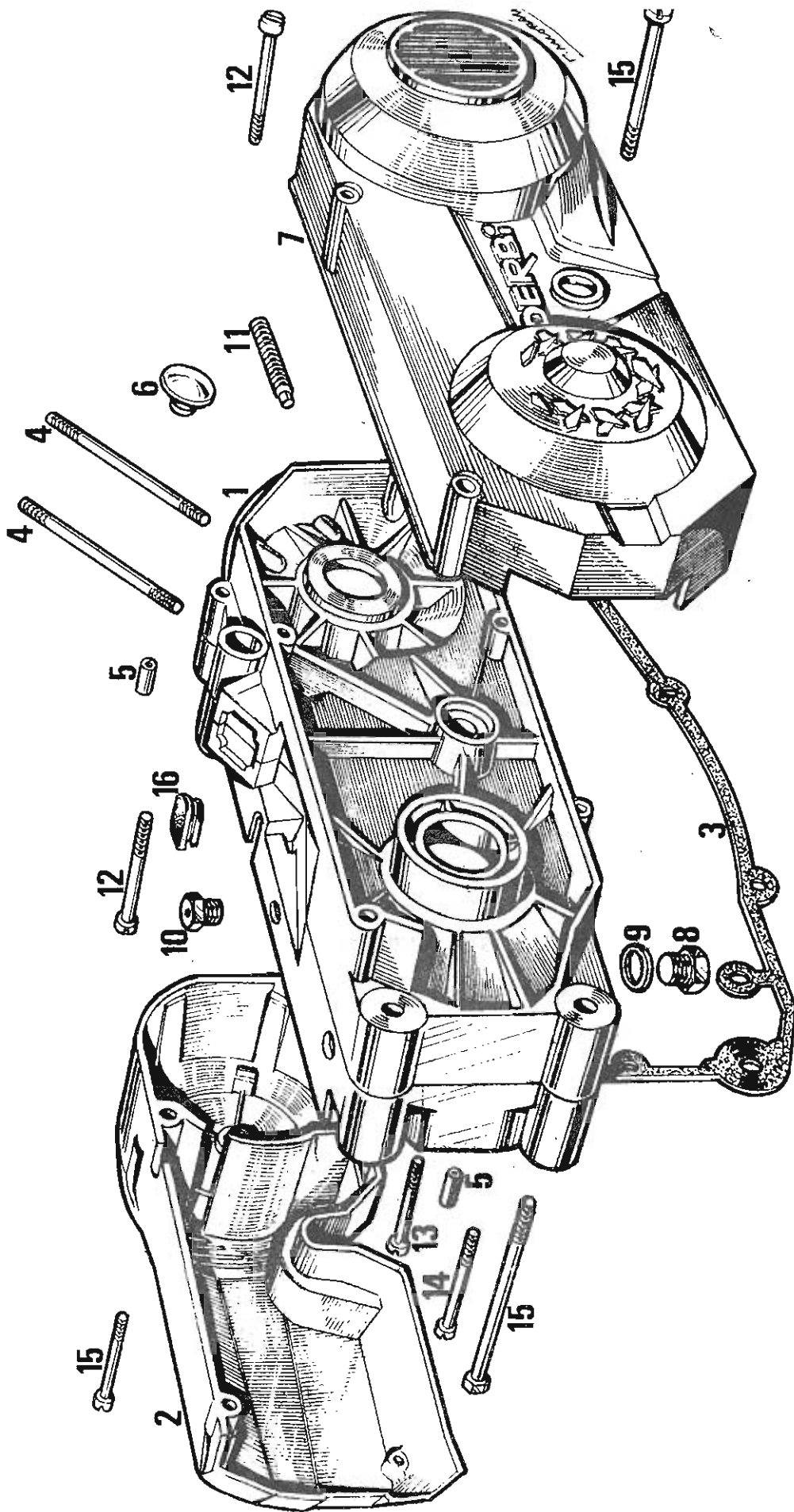

DIAGRAM NO. 11

GROUP: 30 CRANKCASE

	<u>PART NUMBER</u>	<u>DESCRIPTION</u>	<u>PARTS PER GROUP</u>
1	79.30.63.0	CRANKCASE ASSY.	1
2	80.30.20.1	COVER, ALLOY CASE, L.H., BLACK	1
3	79.30.03.0	GASKET, CENTER CRANKCASE	1
4	79.30.05.0	STUD, CYLINDER, 7M X 1.00	4
5	31.30.02.0	DOWEL	2
6	79.30.73.0	PLUG, CASE, RUBBER	2
7	85.30.15.0	COVER, CASE, R.H., BLACK	1
8	56.30.13.0	PLUG, DRAIN	1
9	56.30.12.0	WASHER, DRAIN PLUG	1
10	31.30.08.0	PLUG, FILLER	1
11	25.30.68.0	STUD, MOTOR MOUNT	2
12	82.30.11.0	SCREW, STD. HEAD, 6M X 1.00 X 55	5
13	31.30.09.0	SCREW, STD. HEAD, 6M X 1.00 X 50	3
14	31.30.19.0	SCREW, STD. HEAD, 6M X 1.00 X 45	2
15	31.30.11.0	SCREW, STD. HEAD, 6M X 1.00 X 35	12
16	79.33.28.0	PLUG, CASE, RUBBER	1

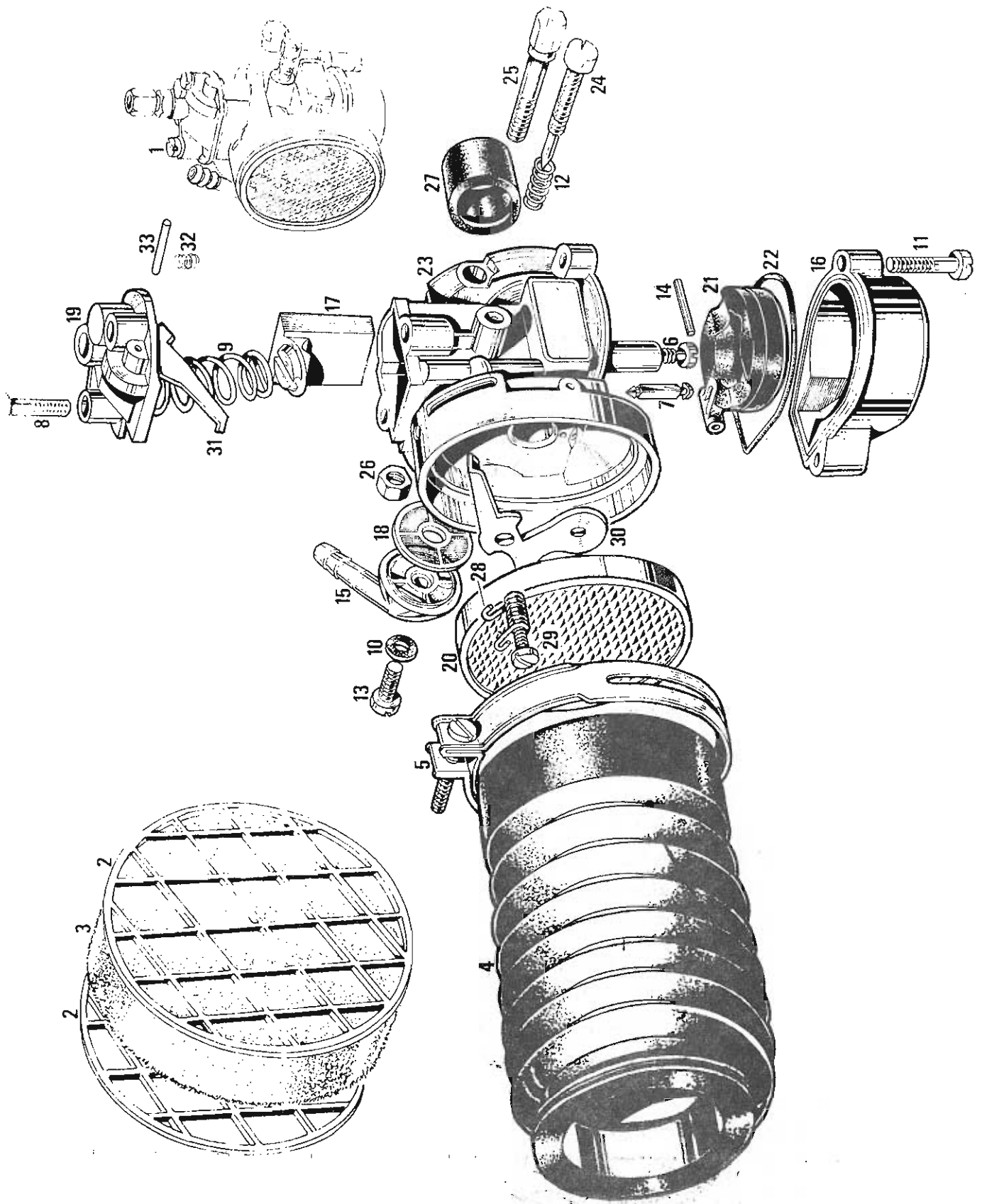

DIAGRAM NO. 12

GROUP: 32 CARBURETOR

	<u>PART NUMBER</u>	<u>DESCRIPTION</u>	<u>PARTS PER GROUP</u>
1	82.32.01.1	CARBURETOR ASSY., 12-12	1
2	25.32.80.0	HOLDER, FILTER	2
3	25.32.25.0	FILTER ELEMENT	1
4	79.32.26.0	AIR BOOT	1
5	35.32.27.0	CLAMP, AIR BOOT	1
6	43.32.03.0	JET, MAIN, #52	1
7	31.32.05.0	VALVE, NEEDLE	1
8	31.32.06.0	SCREW, CARBURETOR TOP CAP	2
9	31.32.07.0	SPRING, CARBURETOR SLIDE	1
10	31.32.08.0	WASHER, FIBER	1
11	31.32.09.0	SCREW, FLOAT BOWL	2
12	31.32.10.0	SPRING, IDLE SCREW	1
13	31.32.11.0	SCREW, FUEL INLET	1
14	31.32.12.0	PIN, FLOAT PIVOT	1
15	31.32.19.0	INLET, FUEL	1
16	31.32.20.0	FLOAT BOWL	1
17	31.32.21.0	SLIDE, CARBURETOR	1
18	31.32.22.0	SCREEN, FILTER	1
19	31.32.23.0	CAP, CARBURETOR	1
20	31.32.25.0	MESH, STEEL CARBURETOR FILTER	1
21	31.32.28.0	FLOAT, CARBURETOR	1
22	31.32.29.0	O'RING, FLOAT BOWL	1
23	31.32.30.0	BODY, CARBURETOR	1
24	31.32.31.0	SCREW, IDLE	1
25	31.32.34.0	BOLT, CARBURETOR CLAMP	1
26	31.32.33.0	NUT, CARBURETOR CLAMP	1
27	31.32.35.0	BUSHING, INTAKE MANIFOLD	1
28	31.32.72.2	SPRING, CHOKE ARM RETURN	1
29	31.32.73.2	SCREW, PIVOT, CHOKE ARM	1
30	11.32.71.0	CHOKE ARM	1
31	11.32.29.0	CHOKE LOCK	1
32	11.32.72.0	SPRING, CHOKE LOCK	1
33	11.32.12.0	PIN, PIVOT, CHOKE LOCK	1

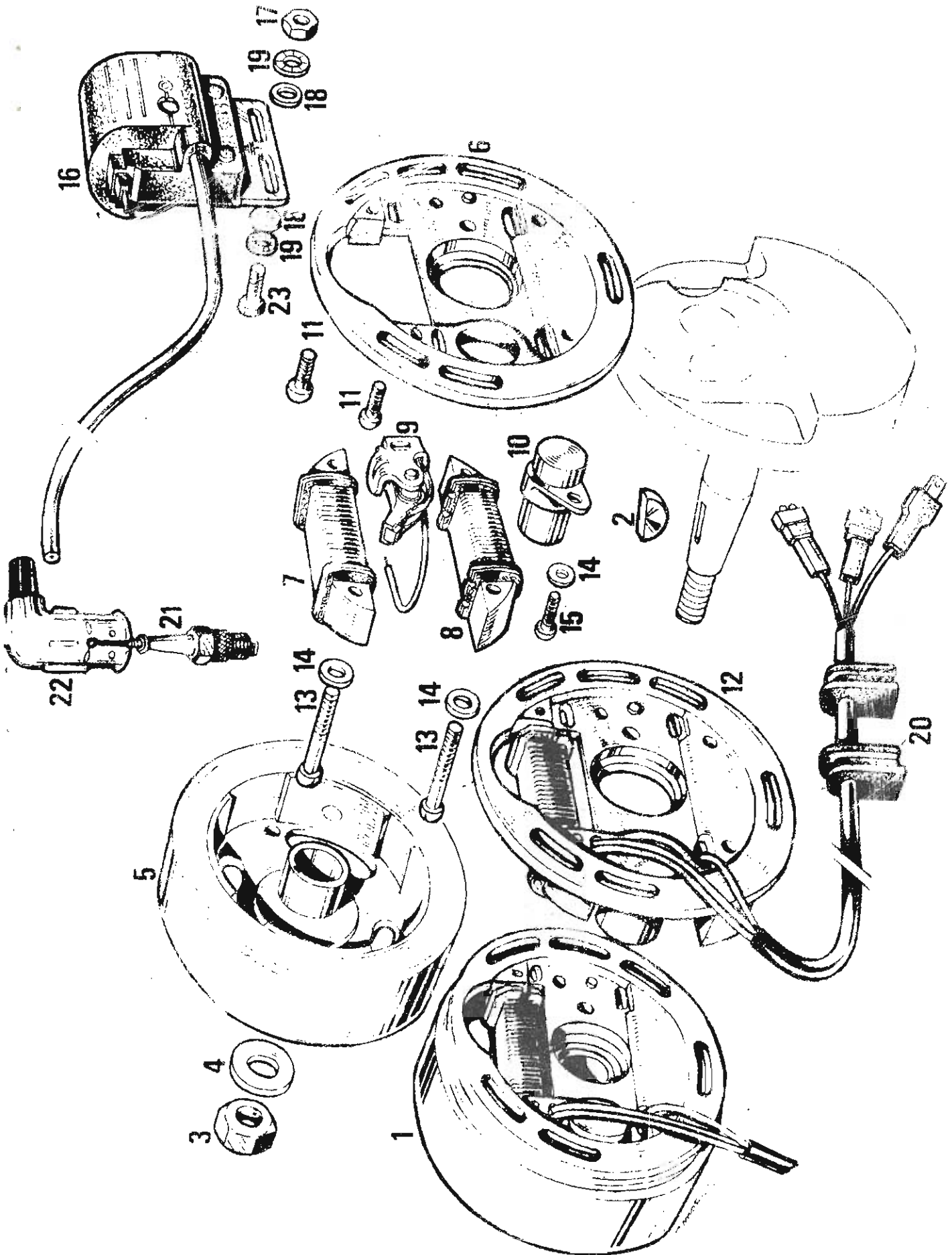

DIAGRAM NO. 13

GROUP: 33 MAGNETO

	<u>PART NUMBER</u>	<u>DESCRIPTION</u>	<u>PARTS PER GROUP</u>
1	50.33.01.0	MAGNETO ASSEMBLY	1
2	31.33.23.0	KEY, FLYWHEEL	1
3	86.33.22.0	NUT, FLYWHEEL, 10M X 1.00	1
4	31.33.24.0	WASHER, FLYWHEEL, 10M	1
5	50.33.12.0	FLYWHEEL	1
6	31.33.02.1	PLATE, STATOR, MAGNETO	1
7	50.33.04.0	COIL, LIGHTING	1
8	50.33.07.0	COIL, IGNITION	1
9	43.33.08.0	POINTS, CONTACT	1
10	31.33.06.0	CONDENSER	1
11	31.33.26.0	SCREW, STATOR PLATE	3
12	50.33.16.0	STATOR PLATE ASSEMBLY	1
13	00.12.4.20	SCREW, COIL MOUNTING 4M X .70 X 20	4
14	00.31.04.0	WASHER, FLAT, 4M	6
15	00.12.4.10	SCREW, CONDENSER, 4M X .70 X 10M	2
16	82.33.17.1	COIL, HIGH VOLTAGE	1
17	00.21.05.0	NUT, 5M X .80	2
18	00.31.05.0	WASHER, FLAT, 5M	4
19	00.34.05.0	WASHER, INTERNAL STAR, 5M	4
20	82.33.28.0	GROMMET, CASE, RUBBER	2
21	11.55.29.0	SPARK PLUG	1
22	79.33.27.0	COVER, SPARK PLUG	1
23	00.02.5.15	BOLT, HEX HEAD, 5M X .80 X 15M	2

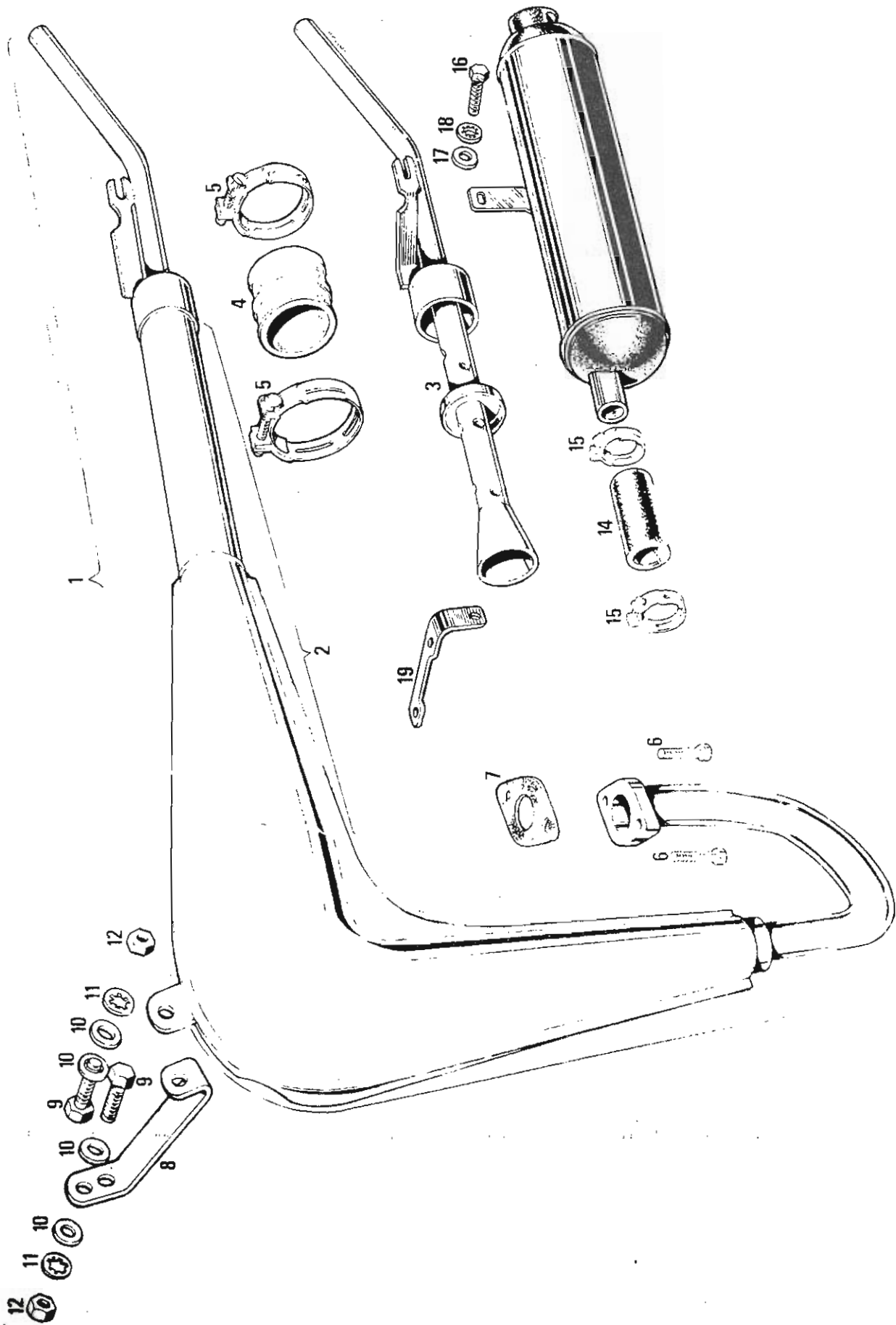

DIAGRAM NO. 14

GROUP: 34 EXHAUST SYSTEM

	<u>PART NUMBER</u>	<u>DESCRIPTION</u>	<u>PARTS PER GROUP</u>
1	79.34.60.0	EXHAUST PIPE UPSWEPT WITH SILENCER	1
2	79.34.61.0	EXHAUST PIPE UPSWEPT W/O SILENCER	1
3	79.34.12.0	SILENCER ASSEMBLY	1
4	25.34.32.0	SLEEVE, SILENCER, RUBBER	1
5	25.34.06.0	CLAMP, SILENCER, SLEEVE	2
6	00.04.6.25	ALLEN BOLT, 6M X 1.00 X 25	2
7	82.34.04.0	GASKET EXHAUST	1
8	79.15.54.0	BRACKET, MOUNTING, EXHAUST	1
9	00.02.6.15	BOLT, HEX HEAD, 6M X 1.00 X 15M	3
10	00.31.06.0	WASHER, FLAT, 6M	6
11	00.34.06.0	WASHER, INTERNAL STAR, 6M	3
12	00.21.06.0	NUT, 6M	3
13	76.34.41.0	AUXILLARY SILENCER	1
14	79.34.24.0	SLEEVE, AUXILLARY SILENCER	1
15	82.04.50.0	CLAMP SLEEVE	2
16	00.02.8.10	BOLT, HEX HEAD, 8M X 1.25 X 10M	1
17	00.31.08.0	WASHER, FLAT, 8M	1
18	00.34.08.0	WASHER, INTERNAL STAR, 8M	1
19	76.34.49.1	MOUNT, EXHAUST PIPE	1

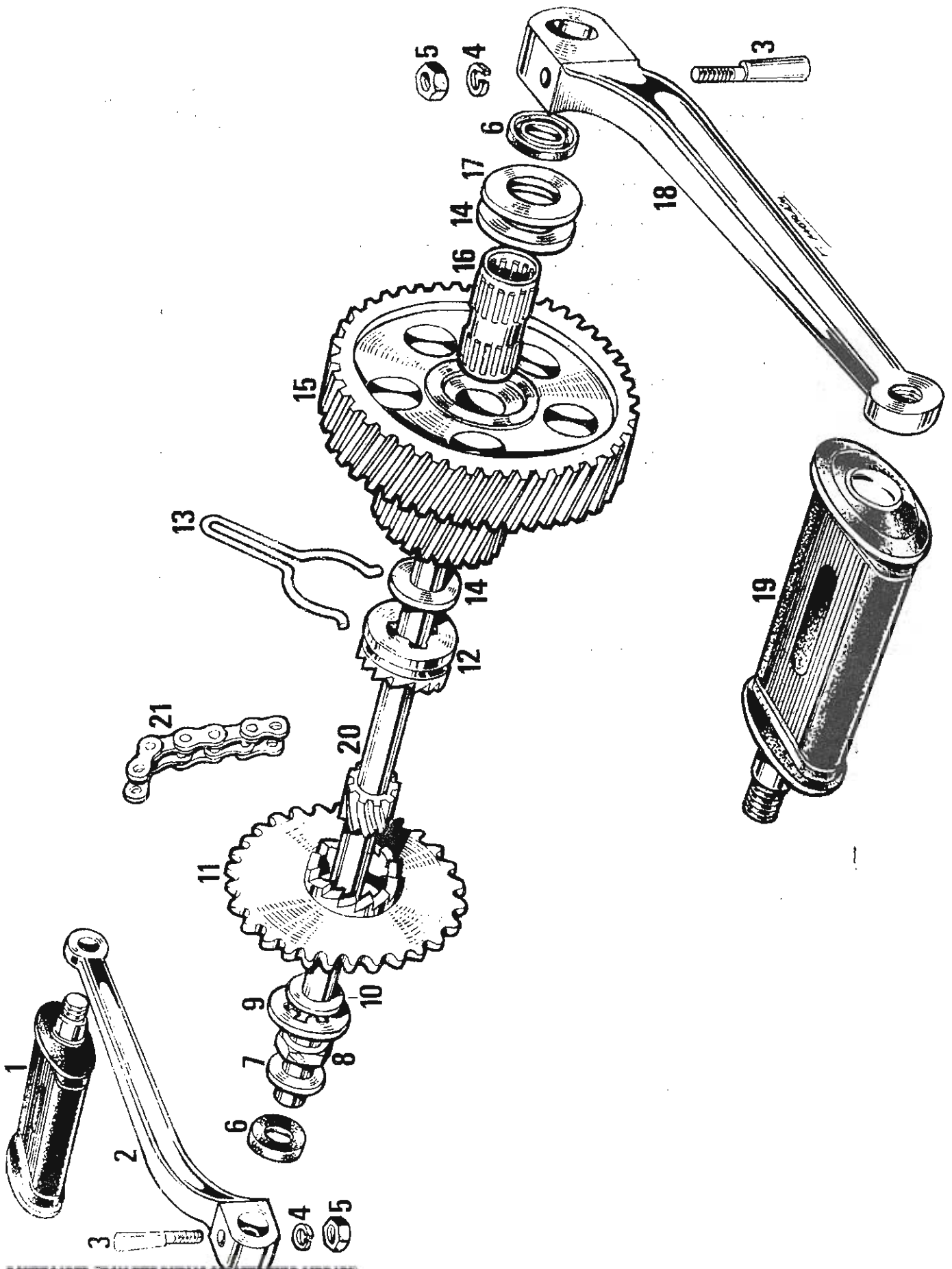

DIAGRAM NO. 15

GROUP: 35 PEDAL DRIVE

	<u>PART NUMBER</u>	<u>DESCRIPTION</u>	<u>PARTS PER GROUP</u>
1	68.34.02.0	PEDAL, L.H.	1
2	82.35.03.0	PEDALCRANK, L.H.	1
3	82.35.04.0	BOLT, TAPERED, 7M X 1.00	2
4	00.33.07.0	WASHER, LOCK, 7M	2
5	00.21.07.0	NUT, 7M X 1.00	2
6	82.35.30.0	SEAL, PEDAL SHAFT	2
7	31.28.25.1	THRUST WASHER	1
8	82.35.39.0	NUT, PEDAL SHAFT	1
9	00.34.19.0	WASHER, LOCK TAB, SPLINED	1
10	82.35.24.0	THRUST WASHER	1
11	50.35.05.1	SPROCKET, PEDAL DRIVE	1
12	82.35.26.0	PEDAL DRIVER	1
13	82.35.32.0	SPRING, PEDAL DRIVER	1
14	82.28.31.0	THRUST WASHER, 2MM	2
15	82.28.96.2	GEAR ASSY.	1
16	82.28.49.2	NEEDLE BEARING	1
17	82.28.31.1	THRUST WASHER 1.4MM	1
18	82.35.13.0	PEDAL CRANK, R.H.	1
19	68.35.12.0	PEDAL, R.H.	1
20	81.35.09.1	PEDAL SHAFT	1
21	82.35.14.0	PEDAL CHAIN	1

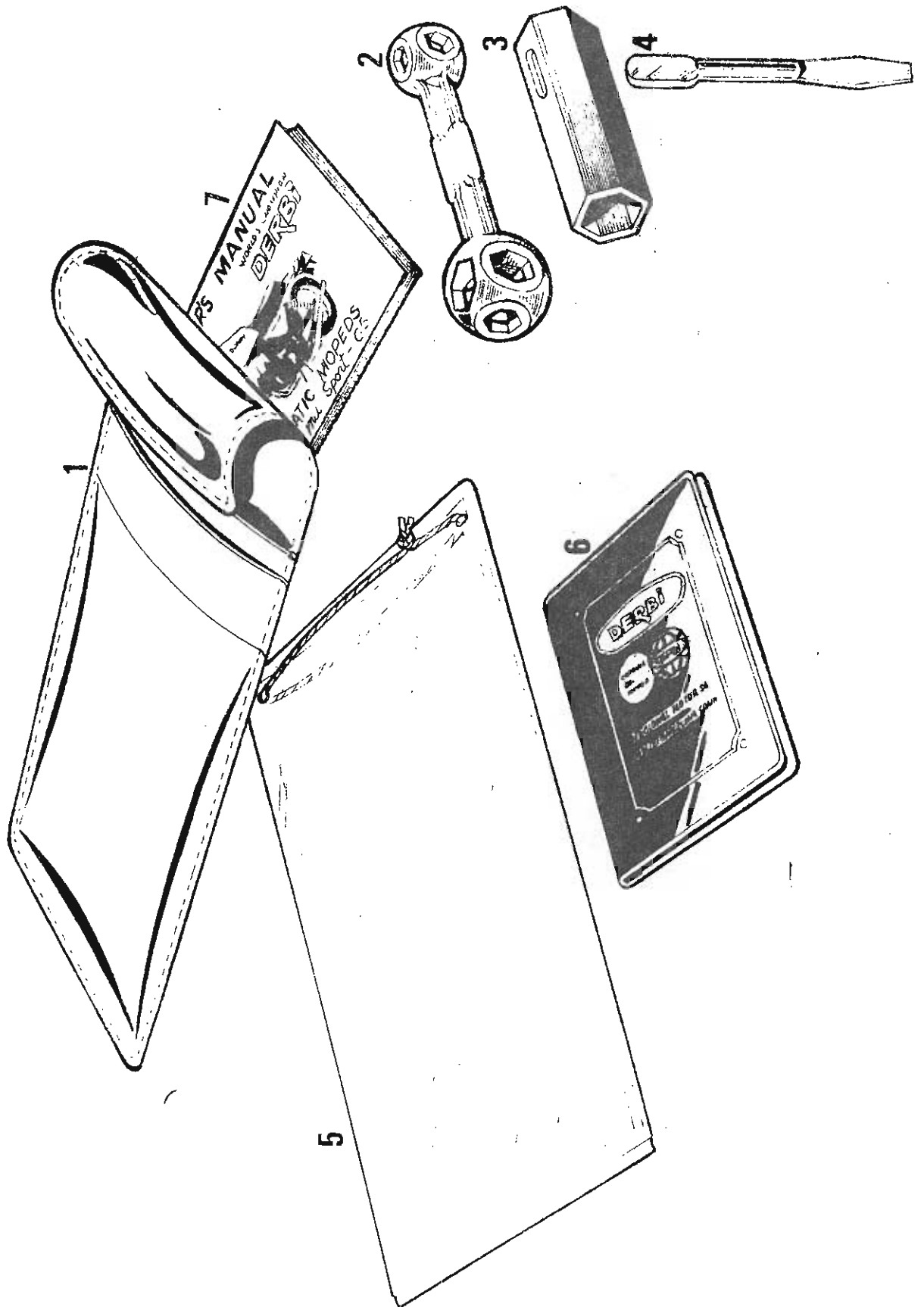

DIAGRAM NO. 16

GROUP: 51 OWNERS KIT

	<u>PART NUMBER</u>	<u>DESCRIPTION</u>	<u>PARTS PER GROUP</u>
1	31.51.11.1	TOOL POUCH	1
2	31.51.23.0	WRENCH, UNIVERSAL BOX	1
3	35.51.02.0	WRENCH, SPARK PLUG	1
4	35.51.03.0	LEVER/SCREWDRIVER	1
5	31.51.30.0	BAG, MANUAL, OWNER	1
6	11.52.24.0	HOLDER, CARD	1
7	50.51.12.1	OWNER'S MANUAL	1

